



THE BEST OF LATVIA'S  
NATURE AND PEOPLE

[www.stali.lv](http://www.stali.lv)

### **"STAĻI" LTD IS ONE OF THE LEADING MANUFACTURERS OF WOODEN WINDOWS AND DOORS IN NORTHERN EUROPE WITH 22 YEARS OF EXPERIENCE**

The company was established in 1993 and in a short period of time, it became one of the leading companies within its sector. Since 1995, "Staļi" Ltd has been offering products of excellent quality made from natural materials for its customers around Europe.

"Staļi" Ltd is a family-owned company that employs more than 300 people. The company manufactures premium quality windows, balcony doors and sliding doors, outer doors and inner doors in accordance with the design chosen by the customer and the customer's requirements. Highly qualified and experienced experts consult with clients, helping them to implement their ideas into our solutions.

The success of our company is determined by: close cooperation with local logging companies, high qualification and extensive experience of employees, availability of the latest manufacturing technologies, efficient manufacturing organization, quality control and perfectly developed delivery of products to customers up to the end user.

"Staļi" Ltd is working with maximum efficiency, using wood for manufacturing of windows and doors, as well as for manufacturing of glued products like beams and boards. Wood chips, a side product, are pressed into wood pellets, which can be further used as heating fuel.

"Staļi" Ltd is a local manufacturer operating responsibly towards the environment, as well as developing an entrepreneurial environment in Latvia.

"Staļi" Ltd is using only environmentally friendly materials. The local traditions for wood processing combined with openness towards innovative solutions, respecting the desires of customers and responsibility about the final result are the main values of the company. Monitoring of all manufacturing processes in compliance with the highest quality standards ensures growth of manufacturing and flawless reputation on the local and external markets.

The main preconditions for high-quality windows and doors are a technologically perfect manufacturing process and complete assembly. Each stage of the process is monitored in accordance with the highest control standards in order to ensure that the finished products are durable and faultless.

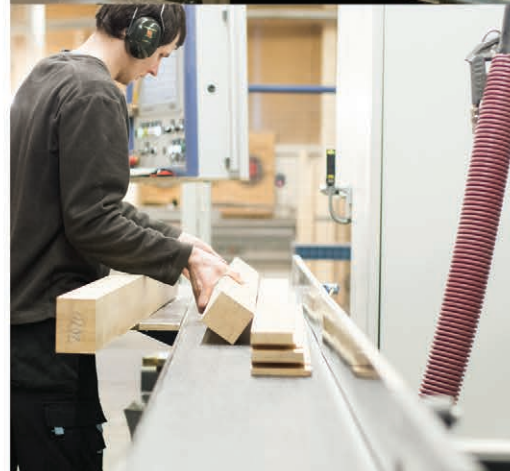

LATVIA



**The total area:** 64,589 km<sup>2</sup>

**Forests:** 29,660 km<sup>2</sup> (45% of the total territory)  
67% coniferous trees,  
33% broad-leaved trees.

**Capital city:** Riga

Latvia has been a Member State  
of the EU since 2004.

## FACTORY IS LOCATED IN CESIS

**Distance from Riga:** ≈ 100 km







• EURO TYPE INWARD OPENING WINDOWS AND BALCONY DOORS	6
• SCANDINAVIAN TYPE OUTWARD OPENING WINDOWS:	
Top Swing Classic	8
Top Swing Opus	9
Side Hung	10
Side Swing	11
Top Hung	12
• SCANDINAVIAN TYPE BALCONY DOORS:	
Outward opening	13
• ENGLISH TYPE WINDOWS:	
Casement	14
Flush Casement	15
• PASSIVE WINDOWS	16
• FIREPROOF WINDOWS	17
• HISTORICAL WINDOWS	18
• DOORS:	
Solid wood entrance doors	19
Panel doors	20
French doors	21
Inner doors	22
• SLIDING DOORS:	
GU lift	23
Roto Patio life	24
Roto Patio Z Tilt & Slide	25
• FOLDING DOORS:	
Inward opening	26
Outward opening	27
• DECORATIVE CROSSBARS	28
• GLASS TYPES	29
• COLOURS	30
• QUALITY	31
• PREMIUM QUALITY WOOD PELLETS	35

# INWARD OPENING

## WINDOWS



Inward opening windows are the most common type of windows used in Europe, due to their easy maintenance. There is a possibility to fully coat these windows with aluminium cladding from the outside, thus ensuring additional protection to the finish and extending the lifetime of the product. These windows can be manufactured in different shapes – rectangular, triangular and in the shape of an arch. The hardware of the company Roto ensures the faultless and long working life of the window mechanism. Roto hardware ensures several ventilation modes.

Inward opening windows can be equipped with the Tilt First function, which can also act as a function for keeping your children safe. Furthermore, handles can be changed to locking handles (lockable via a key or a special button), which safeguards your home against intruders and further guarantees the safety of your children. These windows can be equipped with various types of blinds and insect nets.

### STANDARD SPECIFICATIONS FOR IV68 PROFILE WINDOWS:

Raw material: Finger-jointed pine, solid pine or oak  
Frame: 68 x 82 mm  
Sash: 68 x 82 mm  
Glass: Double glazed (26 mm) with selective coating and argon gas  
Aluminium drainage cover bar  
Handles: Roto Frank  
Hinges: Roto Frank  
Finish: Varnishes or paint from RAL or NCS catalogue

### STANDARD SPECIFICATIONS FOR IV78 PROFILE WINDOWS:

Raw material: Finger-jointed pine, solid pine or oak  
Frame: 78 x 82 mm  
Sash: 78 x 82 mm  
Glass: Triple glazed (36 mm) with selective coating and argon gas  
Aluminium drainage cover bar  
Handles: Roto Frank  
Hinges: Roto Frank  
Finish: Varnishes or paint from RAL or NCS catalogue

### STANDARD SPECIFICATIONS FOR IV90 PROFILE WINDOWS:

Raw material: Finger-jointed pine, solid pine or oak  
Frame: 90 x 82 mm  
Sash: 90 x 82 mm  
Glass: Triple glazed (48 mm) with selective coating and argon gas  
Aluminium drainage cover bar  
Handles: Roto Frank  
Hinges: Roto Frank  
Finish: Varnishes or paint from RAL or NCS catalogue

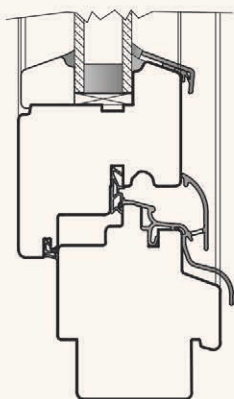

Vertical bottom section of the window

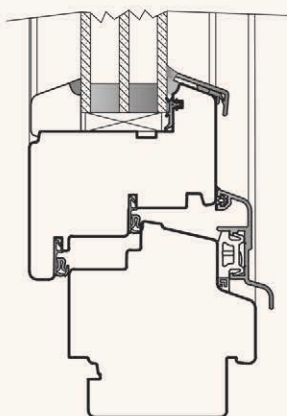

Vertical bottom section of the window

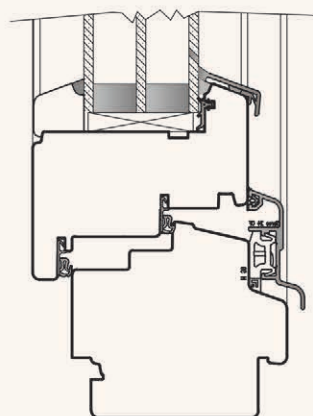

Vertical bottom section of the window

## INWARD OPENING

### BALCONY DOORS



Inward opening or the so called Euro type balcony doors are the most common type of balcony doors used in Europe, including Latvia, due to their easy maintenance. There is a possibility to fully coat these doors with aluminium cladding from the outside, thus ensuring additional protection to the finish and extending the lifetime of the product. These type of doors can be manufactured in different shapes – rectangular, triangular and in the shape of an arch. The hardware provided by the company Roto ensures faultless and long working life of the door mechanism.

Roto hardware ensures several ventilation modes:

- Intensive ventilation – door sash fully open
- Regular ventilation – door sash tilted by 10 cm
- Winter ventilation – the handle turned by 45°, the door sash tilts only by 7 mm

We offer 3 types of profile for balcony doors: IV68, IV78, and IV90.

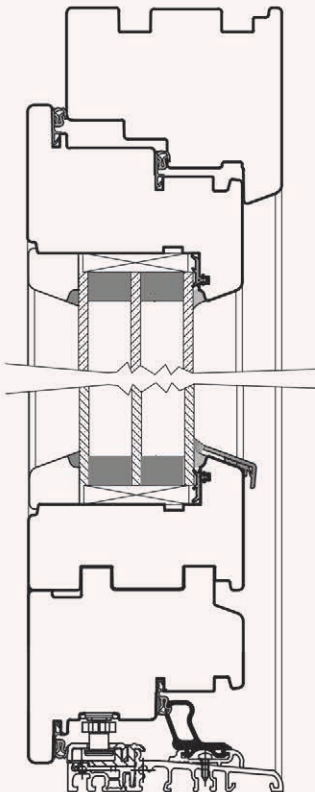

Vertical bottom section of the doors

#### STANDARD SPECIFICATIONS FOR IV68 PROFILE INWARD OPENING BALCONY DOORS:

Raw material: Finger-jointed pine, solid pine or oak  
 Frame: 68 x 82 mm  
 Sash: 68 x 82 mm  
 Glass: Double glazed (26 mm) with selective coating and argon gas  
 Aluminium drainage cover bar  
 Handles: Roto Frank  
 Hinges: Roto Frank  
 Finish: Varnishes or paint from RAL or NCS catalogue

#### STANDARD SPECIFICATIONS FOR IV78 PROFILE INWARD OPENING BALCONY DOORS:

Raw material: Finger-jointed pine, solid pine or oak  
 Frame: 78 x 82 mm  
 Sash: 78 x 82 mm  
 Glass: Triple glazed (36 mm) with selective coating and argon gas  
 Aluminium drainage cover bar  
 Handles: Roto Frank  
 Hinges: Roto Frank  
 Finish: Varnishes or paint from RAL or NCS catalogue

#### STANDARD SPECIFICATIONS FOR IV90 PROFILE INWARD OPENING BALCONY DOORS:

Raw material: Finger-jointed pine, solid pine or oak  
 Frame: 90 x 82 mm  
 Sash: 90 x 82 mm  
 Glass: Triple glazed (48 mm) with selective coating and argon gas  
 Aluminium drainage cover bar  
 Handles: Roto Frank  
 Hinges: Roto Frank  
 Finish: Varnishes or paint from RAL or NCS catalogue

# SCANDINAVIAN TYPE OUTWARD OPENING

## TOP SWING WINDOWS CLASSIC



Spilka Classic hinges with their unique construction make it possible to turn the window fully inside, thus making the maintenance of the window very convenient and simple. The hinge construction is equipped with a regular stop, which limits the initial opening of the window to 100 mm and operates also in cases when the window is turned by 180°. The turning lock is very useful when there are small children present, thus limiting the possibilities of opening the window. The design of the window and hinge construction ensure the secure balance of the sash if you

turn the window so that the external part turns inside. The Top Swing Classic window has been tested in the SP Technical Research Institute of Sweden, and the wooden/aluminium window has obtained the certificate of „P” marking ([www.sp.se](http://www.sp.se)).

These windows can be manufactured from wood or a combination of wood and aluminium where aluminium covers the outer part of the frame and sash.

### STANDARD SPECIFICATIONS FOR TOP SWING CLASSIC WOODEN WINDOWS:

Raw material: Finger-jointed pine, solid pine or oak

Frame: 95 x 57 mm or 105 x 57 mm

Sash: 76 x 65 mm

Glass: Double glazed (24 mm) or triple glazed

(36 mm) with selective coating and argon gas

Aluminium drainage cover bar

Plastic glass beads with glass sealing rubber from outside

Hardware: Spilka

Handle: Hoppe

Finish: Varnishes or paint from RAL

or NSC catalogue

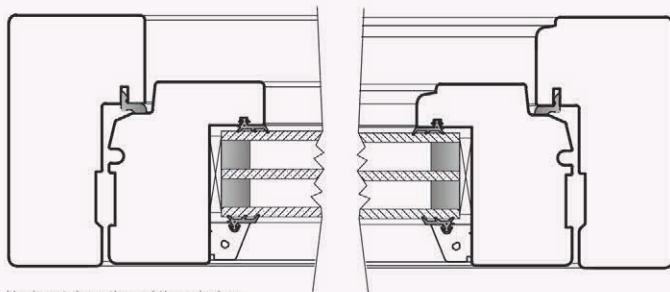
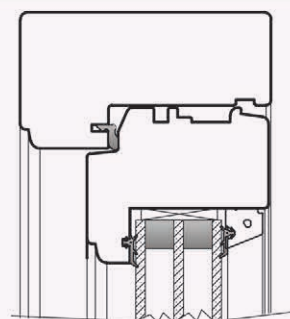

Horizontal section of the window

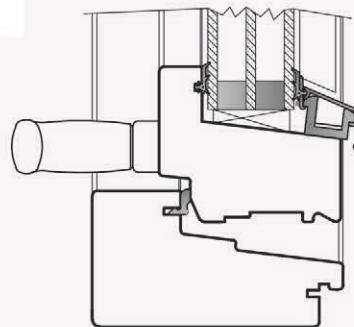

Vertical section of the window

## SCANDINAVIAN TYPE OUTWARD OPENING

### TOP SWING WINDOWS OPUS

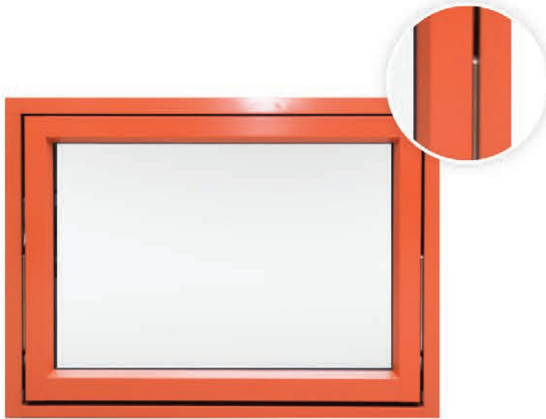

Spilka Opus hinges with their unique construction make it possible to turn the window fully inside, thus making the maintenance of window very convenient and simple. The main feature of Spilka Opus hinges is that they are mounted between the frame and sash and placed in a groove in the side of the window. Because of that, hinges are "hidden" and almost invisible from the

external side and not affecting the exterior, which can be very useful. It is possible to turn window by 180°, making cleaning this type of window easy and more secure.

These windows can be manufactured from wood or a combination of wood and aluminium where aluminium covers the outer part of the frame and sash.

#### STANDARD SPECIFICATIONS FOR TOP SWING OPUS WOODEN WINDOWS:

Raw material: Finger-jointed pine, solid pine or oak  
Frame: 95 x 57 mm or 105 x 57 mm  
Sash: 76 x 65 mm  
Glass: Double glazed (24 mm) or triple glazed (36 mm) with selective coating and argon gas  
Aluminium drainage cover bar  
Plastic glass beads with glass sealing rubber from outside  
Hardware: Spilka  
Handle: Hoppe  
Finish: Varnishes or paint from RAL or NSC catalogue

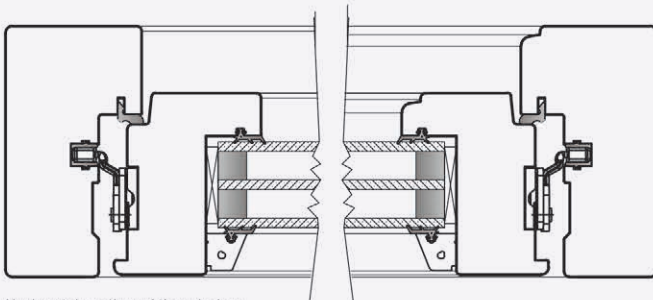
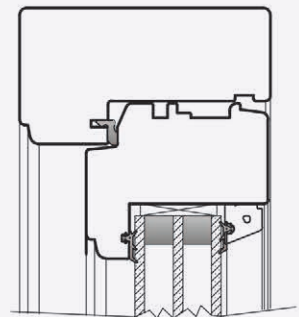

Horizontal section of the window

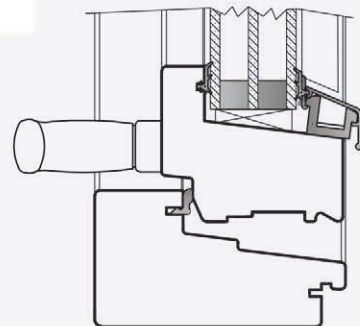

Vertical section of the window

# SCANDINAVIAN TYPE OUTWARD OPENING

## SIDE HUNG WINDOWS



Scandinavian side hung windows open outwards and glass sealing rubber strips are used in place of silicone. The Scandinavian type side hung windows are distinguished by the simplicity of the structure.

The window construction is equipped with a regular stop, which limits the initial opening of the window up to 100 mm.

The turning lock is very useful, when small children are present, thus limiting the possibilities of opening the window. Hoppe Tokyo handles or sash hooks are available options to choose as locking mechanism.

These windows can be manufactured from wood or a combination of wood and aluminium where aluminium covers the outer part of the frame and sash.

### STANDARD SPECIFICATIONS FOR SIDE HUNG WOODEN WINDOWS:

Raw material: Finger-jointed pine, solid pine or oak  
Frame: 95 x 57 mm or 105 x 57 mm  
Sash: 76 x 65 mm  
Glass: Double glazed (24 mm) or triple glazed (36 mm) with selective coating and argon gas  
Aluminium drainage cover bar  
Plastic glass beads with glass sealing rubber  
Hardware: Spilka  
Handle: Hoppe  
Finish: Varnishes or paint from RAL or NCS catalogue

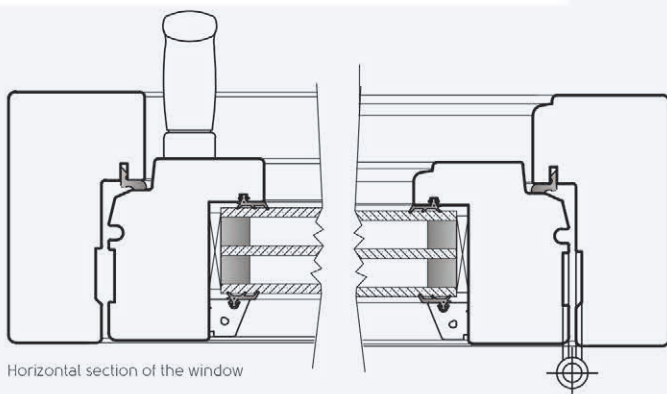
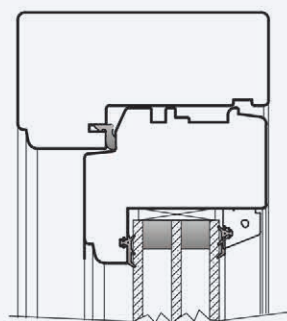
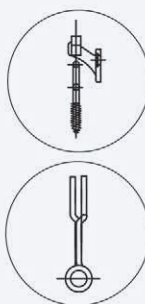

Horizontal section of the window

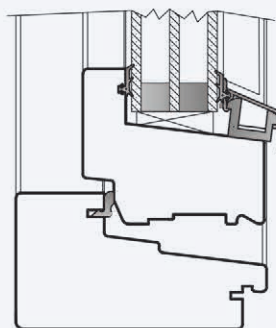

Vertical section of the window

# SCANDINAVIAN TYPE OUTWARD OPENING

## SIDE SWING WINDOWS



Side swing windows open and turn outwards. The unique hinge construction of these windows makes it possible to turn the window fully inside, thus making the maintenance of window very convenient and simple.

The hinge construction is equipped with a regular stop, limiting the initial opening of the window up to 100 mm and operates also when the window is turned 180°. The turning lock is very useful, when small children are

present, thus, limiting the possibilities of opening the window. Hinges are fixed in both side edges of the window frame. The design of the window and hinge construction ensures the secure balance of the sash, if you turn the window inside with the external part.

These windows can be manufactured from wood or a combination of wood and aluminium where aluminium covers the outer part of the frame and sash.

### STANDARD SPECIFICATIONS FOR SIDE SWING WOODEN WINDOWS:

Raw material: Finger-jointed pine, solid pine or oak  
 Frame: 95 x 57 mm or 105 x 57 mm  
 Sash: 76 x 65 mm  
 Glass: Double glazed (24 mm) or triple glazed (36 mm) with selective coating and argon gas  
 Aluminium drainage cover bar  
 Plastic glass beads with glass sealing rubber  
 Hardware: Spilka  
 Handle: Hoppe  
 Finish: Varnishes or paint from RAL or NCS catalogue

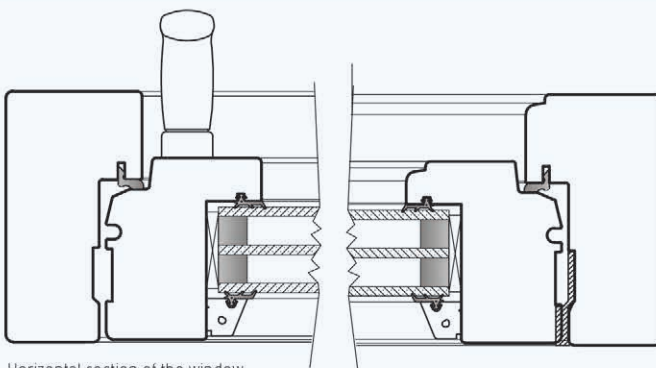
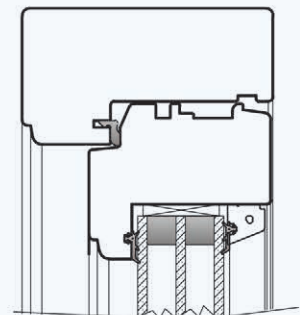

Horizontal section of the window

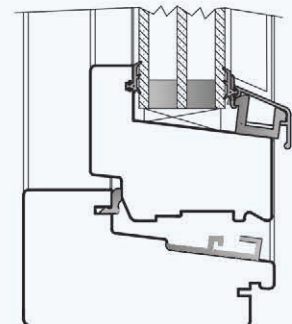

Vertical section of the window

# SCANDINAVIAN TYPE OUTWARD OPENING

## TOP HUNG WINDOWS



The unique features of Scandinavian Top Hung windows are their simplicity and practical use. Hinges are fitted on the upper part of the window, it can be opened outward and fixed in a ventilation mode with a special ASSA fixator attached on the right side of the window, whereas the handle is located on the bottom part of the window sash.

This type of window is commonly used in basements of buildings, when the main purpose of the window is to ensure daylight. These windows can be manufactured from wood or a combination of wood and aluminium where aluminium covers the outer part of the frame and sash.

### STANDARD SPECIFICATIONS FOR TOP HUNG WOODEN WINDOWS:

Raw material: Finger-jointed pine, solid pine or oak  
Frame: 95 x 57 mm or 105 x 57 mm  
Sash: 76 x 65 mm  
Glass: Double glazed (24 mm) or triple glazed (36 mm) with selective coating and argon gas  
Aluminium drainage cover bar  
Plastic glass beads with glass sealing rubber  
Hardware: Spilka, IPA  
Handle: Hoppe or "Casement" hooks  
Finish: Varnishes or paint from RAL or NCS catalogue

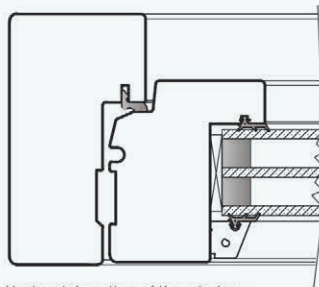
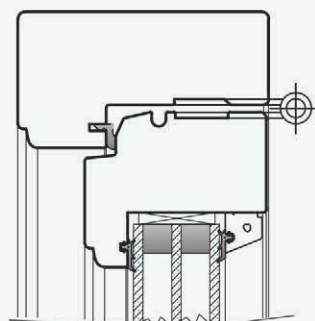
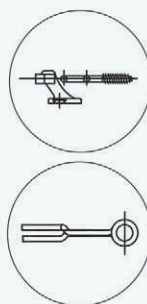

Horizontal section of the window

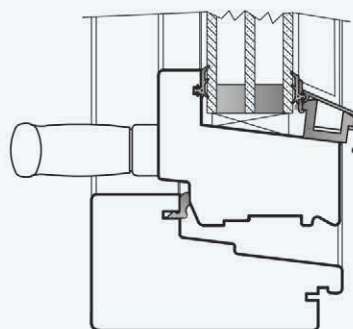
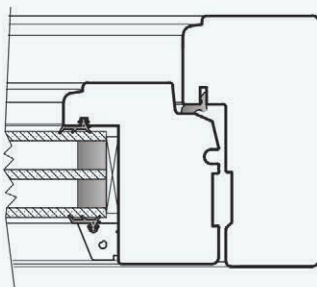

Vertical section of the window

## SCANDINAVIAN TYPE OUTWARD OPENING

### BALCONY DOORS



Scandinavian type outward opening balcony doors are possible to fix in any ventilation mode with the help of a handle. These doors can be combined with openable windows or fixed frame windows. Three different threshold options are available – low aluminium threshold 22 mm, pine/aluminium 42 mm or oak threshold 57 mm.

As with the windows, the balcony doors are tested in the SP Technical Research Institute of Sweden, and the wooden/aluminium doors have obtained the certificate of "P" marking ([www.sp.se](http://www.sp.se)). These doors can be manufactured from wood or a combination of wood and aluminium where aluminium covers the outer part of the frame and sash.

#### STANDARD SPECIFICATIONS FOR SCANDINAVIAN BALCONY DOORS:

Raw material: Finger-jointed pine, solid pine or oak  
 Frame: 95 x 57 mm or 105 x 57 mm  
 Sash: 76 x 78 mm  
 Glass: Double glazed (24 mm) or triple glazed (36 mm) with selective coating and argon gas  
 Low aluminium threshold, pine/aluminium threshold or oak threshold  
 Plastic glass beads with glass sealing rubber from outside  
 Glass sealing rubber from inside and outside  
 3-point key  
 Hardware: ASSA Fix  
 Handle: Hoppe Tokyo with a latch from inside  
 Wooden/aluminium doors have "P" marking ([www.sp.se](http://www.sp.se))  
 Finish: Varnishes or paint from RAL or NCS catalogue

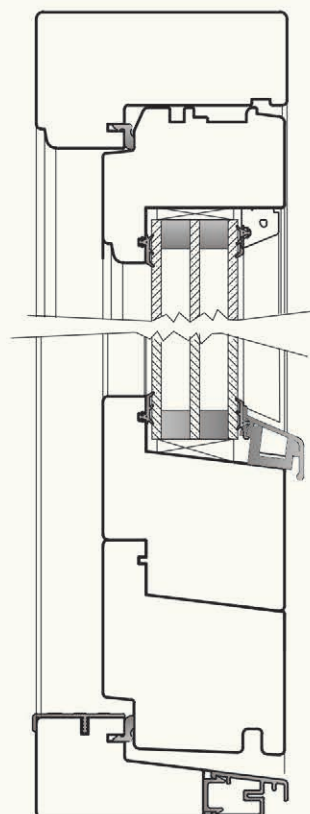

Vertical bottom section of the doors

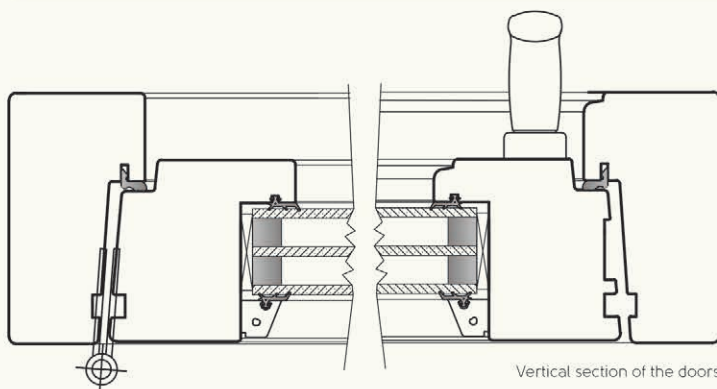

Vertical section of the doors

# ENGLISH TYPE WINDOWS

## CASEMENT



Casement windows open to the outside and up to 90 degrees. Thickness of the frame is 69 mm and double glazing is used. Hinges are fixed to both upper and lower edge. Casement windows are completed with Wintlock hardware. Special safety hooks can be fixed to casement windows to ensure additional safety.

Design of the window and hinge construction achieves a safe balance of the sash even when the window is fully opened.

Windows are tested at the BSI Testing Institution in the UK and comply with BS 7950 standards.

### STANDARD SPECIFICATIONS FOR CASEMENT WINDOWS:

Raw material: Finger-jointed pine, solid pine or oak

Frame: 71 x 69 mm

Sash: 63 x 69 mm

Glass: Double glazed (24 mm) with selective coating and argon gas

Wooden drainage cover

Ventilation opening

Safety hooks

Hardware: Wintlock, Kenrick and Costwold

Handle: Bombardier

Finish: Varnishes or paint from RAL or NCS catalogue

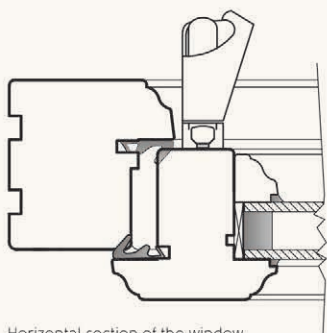
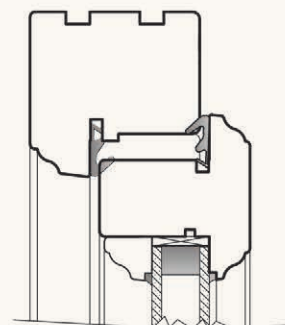

Horizontal section of the window

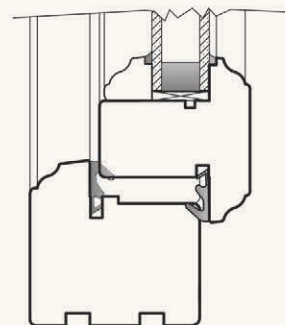
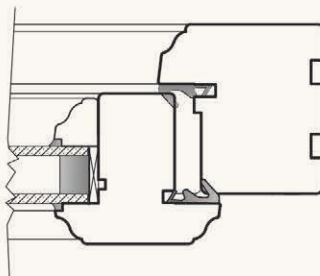

Vertical section of the window

# ENGLISH TYPE WINDOWS

## FLUSH CASEMENT



The frame and sash of the Flush Casement window are flat from outside, grooveless, and this window can be opened at an angle of up to 90 degrees. The various colour, design and glazing options provide an opportunity to adjust this window to the exterior of the house. Flush Casement Winlock hardware ensures perfect operation for many years.

The Flush Casement window, manufactured by "Stali" Ltd, also has excellent thermal properties and high resistance against different weather conditions. This high-quality and energy efficient window will not only bring the feeling of warmth and safety into your house, but also will integrate harmoniously into the house design.

### STANDARD SPECIFICATIONS FOR FLUSH CASEMENT WINDOWS:

Raw material: Finger-jointed pine, solid pine or oak  
Frame: 92 x 69 mm  
Sash: 63 x 69 mm  
Glass: Double glazed (24 mm) with selective coating and argon gas  
Wooded drainage cover  
Ventilation opening  
Safety hooks  
Hardware: Winlock, Kenrick and Costwold  
Handle: Bombardier  
Finish: Varnishes or paint from RAL or NCS catalogue

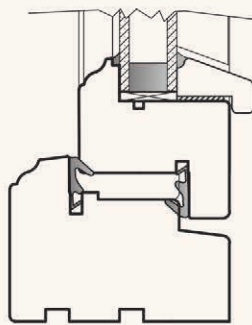

Vertical section of the window

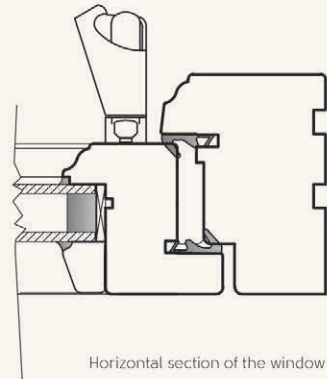

Horizontal section of the window

# PASSIVE WINDOWS



Due to the achievements in sustainable development and energy efficient houses, people are increasingly aware of the reduction of heat energy loss. "Stalji" Ltd offers high performance passive windows, which comply with the highest international requirements for passive windows. Passive houses – a vision for the future and a house with high energy efficiency.

The main qualities of passive houses are excellent heat insulation, leak proofing, heat recovery from the outflow air and qualitative low energy consumption windows and doors. "Stalji" Ltd offers outward opening passive windows with U value equal to 0.59 and inward opening passive windows with the U value equal to 0.62.

## STANDARD SPECIFICATIONS FOR INWARD IV90 PASSIVE WINDOWS:

Raw material: Finger-jointed pine and greenteQ Climate Conformal  
 Frame: 90 x 78 mm  
 Sash: 90 x 78 mm  
 Glass: Triple glazed (48 mm) selective coating and argon gas  
 Aluminium drainage cover bar  
 Handles: Roto Frank  
 Hardware: Roto Frank  
 Finish: Varnishes or paint from RAL or NCS catalogue

## STANDARD SPECIFICATIONS FOR OUTWARD IV105 PASSIVE WINDOWS:

Raw material: Finger-jointed pine and greenteQ Climate Conformal  
 Frame: 105 x 57 mm  
 Sash: 90 x 65 mm  
 Hinges: Open 180° horizontally (Spilka)  
 Glass: Triple glazed (48 mm) with selective coating and argon gas  
 Aluminium drainage cover bar  
 Plastic glass beads with glass sealing rubber from outside  
 Hardware: Spilka  
 Handle: Hoppe  
 Finish: Varnishes or paint from RAL or NSC catalogue

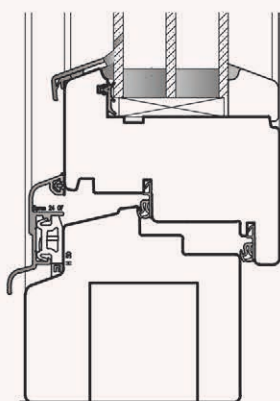

Vertical bottom section of the window

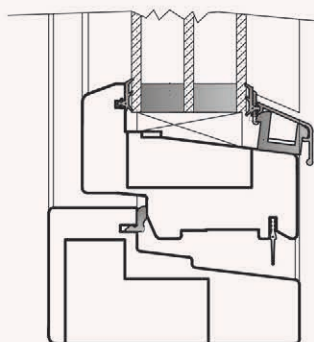

Vertical bottom section of the window



The fireproof windows manufactured by "Stalji" Ltd comply with EI45 characteristics of fireproof windows and maintain the structure integrity even at particularly high temperatures and in case of flames – for at least 45 minutes. This window is equipped with a fire resistant glass



and insulating tape between the window sash and frame, which expands at particularly high temperatures, thereby preventing air inflow. Fire resistant sealing rubber and silicone is also used, which ensures sustainable resistance against the spread of smoke and fire.

## STANDARD SPECIFICATIONS FOR INWARD OPENING IV90 FIREPROOF WINDOWS:

Raw material: Oak  
Frame: 90 x 82 mm  
Sash: 90 x 82 mm  
Glass: Double glazed (36 mm) with selective coating and argon gas  
Aluminium drainage cover bar  
Handles: Roto Frank  
Hinges: Roto Frank  
Finish: Paint from RAL or NCS catalogue

## STANDARD SPECIFICATIONS FOR OUTWARD OPENING IV105 FIREPROOF WINDOWS:

Raw material: Oak  
Frame: 105 x 57 mm  
Sash: 76 x 65 mm  
Hinges: Open 180° horizontally (Spilka Classic)  
Glass: Double glazed (28 mm)  
Aluminium drainage cover bar  
Hardware: Spilka  
Handle: Hoppe Tokyo  
Finish: Paint from RAL or NCS catalogue

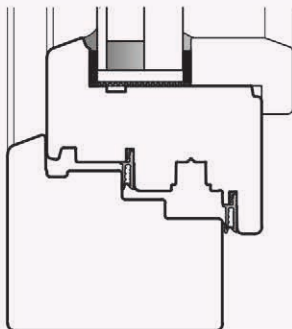

Vertical bottom section of the window

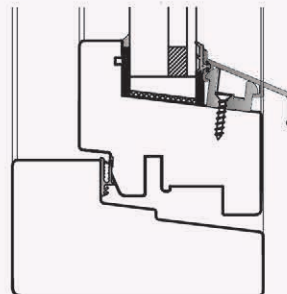

Vertical bottom section of the window

## HISTORICAL WINDOWS



"Stalī" Ltd offers a wide range of window safety solutions and hinge systems in the manufacturing of copies of historical windows, combining the decorative and design solutions of the original window with modern technologies and solutions, that improve thermal efficiency, durability and safety of the window.

It is possible to choose windows made from solid wood or finger-jointed wood. The wide choice of handles, decors and colours will allow matching these windows with any type of architecture and making them match the original as closely as possible, combined with a thermal efficiency that complies with modern requirements.

"Stalī" Ltd can be proud of many years of experience and extensive number of implemented projects, particularly in manufacturing historical windows in Latvia and other countries.

Historical windows can be manufactured in various shapes and sizes, adjusting them to the needs of each particular project. Windows can have a rectangular, triangular, circular or any other shape. They can be openable or fixed.

Historical windows can be varnished or painted in colours and tones that match the interior, at the same time preserving the original texture of wood. The design options depend on individual requirements and desires of the customer.



## ENTRANCE DOORS

### SOLID WOOD



"Stalji" Ltd offers high-quality entrance doors according to Western European standards. We are not limited to a few standard designs. Designs and size of doors are made combining the client's wishes and our possibilities. Doors are equipped with high security multi point locking mechanisms by default. They may also be equipped with a peephole, mailbox, electronic locking mechanisms of the latest technologies and other accessories. Different

wood types can be used as a material. Most common are pine and oak. Doors can be painted or varnished in any colour from NCS or RAL catalogues.

The exterior doors produced by "Stalji" Ltd can be combined with sidelights and toplights, as well as many types of decorative, toned or matte-finished glass, as per the client's wishes.

#### STANDARD SPECIFICATIONS FOR CLASSICAL SYSTEM SOLID WOOD ENTRANCE DOORS OF 68 MM, 78 MM AND 90 MM THICKNESS:

Raw material: Finger-jointed pine, solid pine or oak  
Frame: 68, 78, 90 x 82 mm  
Sash: 68, 78, 90 x 138 mm  
Glass: Double or triple glazed (26-48 mm) with selective coating and argon gas, or wood panel  
Hardware: KfV  
Handles: On client's choice  
Hinges: Simonswerk  
Finishing: Remmers varnishes or paint from RAL or NCS catalogue

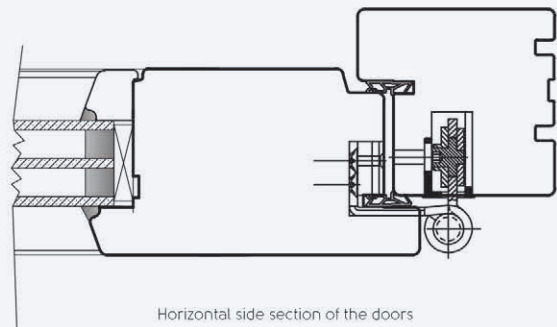

Horizontal side section of the doors

## PANEL DOORS



Panel doors are made from a panel glued from both sides and designed by "Stajli" Ltd. In order to ensure safety and durability of these doors and to guarantee resistance against the effect of humidity and bending, metal plates are integrated in the panel from both sides. For better energy efficiency, the panel is filled with an insulating material.

These doors can be manufactured in almost unlimited variations of design, matching the customer's specifications with the abilities of "Stajli" Ltd. To ensure better functionality, we offer only the best locking mechanisms and handles from ASSA and KfV.

### STANDARD SPECIFICATIONS FOR PANEL DOORS OF 68 MM, 78 MM AND 90 MM THICKNESS:

Raw material: Finger-jointed pine, solid pine or oak  
 Frame: 68, 78 x 82 mm or 105 x 57mm  
 Sash: 68, 78 mm  
 Raw material sash: Larch or oak panel  
 Glass: Double or triple glazed (26–36 mm) with selective coating and argon gas  
 Hardware: KfV or ASSA  
 Handles: On client's choice  
 Hinges: Simonswerk  
 Finish: Remmers varnishes or paint from RAL or NCS catalogue

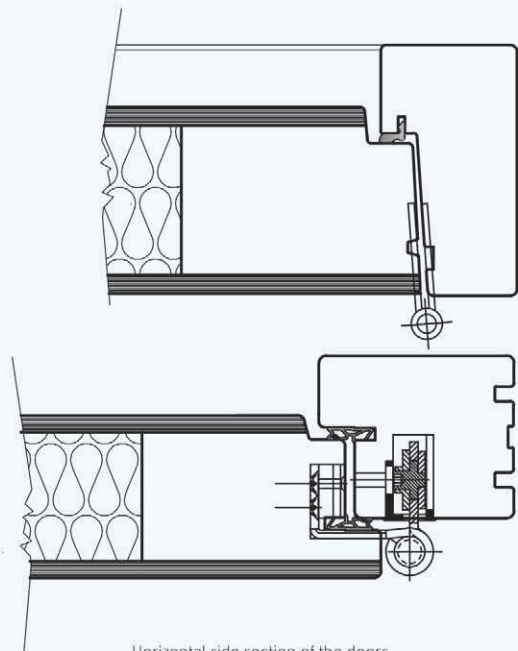

Horizontal side section of the doors



Hinged patio doors or so-called French doors are distinguished by classical simplicity – the handle fixes the doors to lock them. French doors are fully glazed, with one or two simultaneously openable sashes. By connecting living spaces and preserving the air flow, French doors give special grace and elegance to the interior.

Wooden doors can be combined with windows or fixed frame windows. Another option is wooden doors with aluminium cladding. "Stalji" Ltd manufactures outward or inward opening French doors.

## STANDARD SPECIFICATIONS SPECIFICATIONS FOR FRENCH DOORS:

Raw material: Finger-jointed pine, solid pine or oak  
Frame: 71 x 69 mm  
Sash: 63 x 115 mm  
Glass: Double glazed (24 mm) with selective coating and argon gas or panel  
Hardware: ERA, Winlock  
Handle: Bombardier  
Hinges: Nico 3D  
Threshold: Stormguard  
Finish: Varnishes or paint from RAL or NCS catalogue

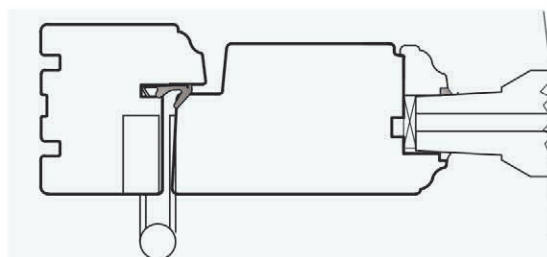
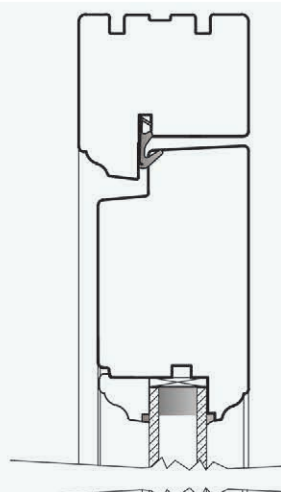

Horizontal section of the doors

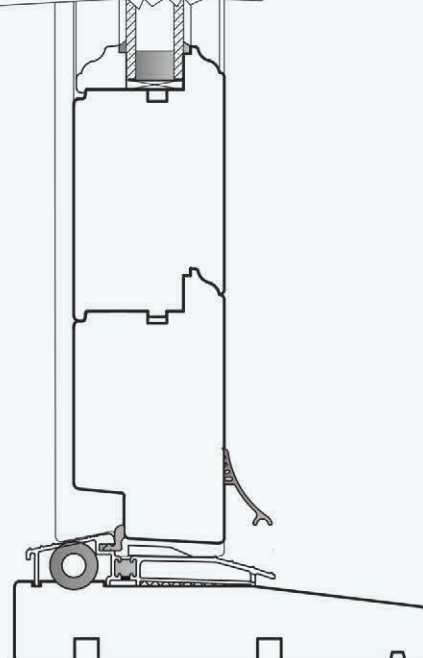

Vertical section of the doors

## INNER DOORS



"Stalji" Ltd offers inner doors with one or two sashes made from pine or oak with wooden or glass panels according to the design chosen by the customer. Natural wooden materials ensure good sound insulation, easy maintenance and visual attraction.

Wooden inner doors are natural and pleasant to use. These doors can be painted or treated with special varnishes, matching them with the interior and guaranteeing resistance against moisture or other external environmental factors.

### STANDARD SPECIFICATIONS FOR CLASSICAL SYSTEM WOODEN INNER DOORS OF 45 MM THICKNESS:

Raw material: Finger-jointed pine, solid pine or oak  
 Frame: 60 x 82 mm  
 Sash: 45 x 115 mm  
 6 mm thick glass, wooden panel or 20 mm double glazing  
 Hardware: KfV  
 Handles: On client's choice  
 Hinges: Exacta 3D  
 Finish: Remmers varnishes or paint from RAL or NCS catalogue

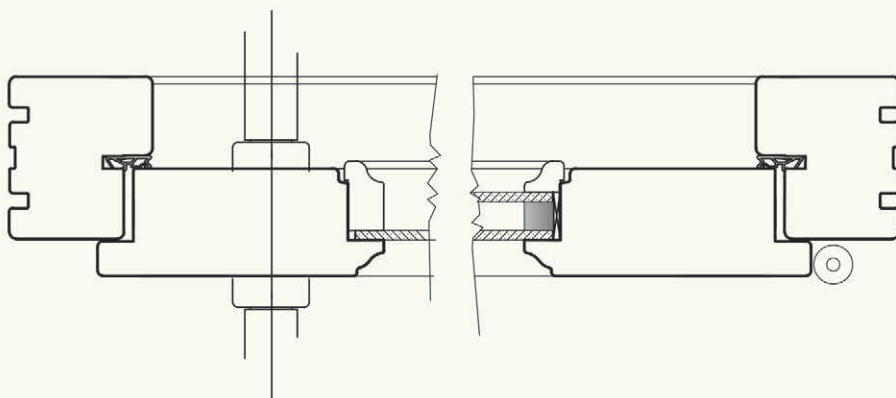
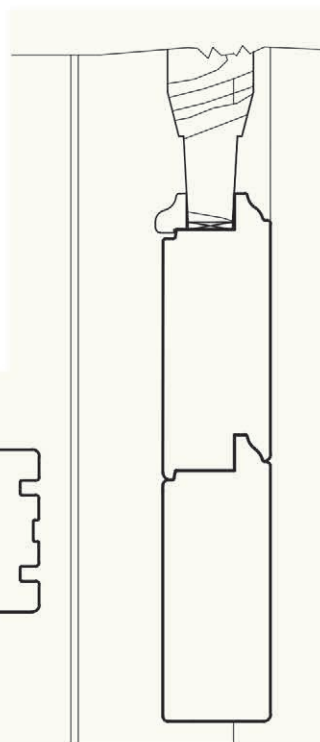

Horizontal section of the doors

Vertical bottom section of the doors



Sliding wooden doors are a good alternative both for inner and outer doors. They require little space, thereby rooms can be used optimally. Sliding doors extend the space, ensuring a similar flow of light as a window. Sliding doors are becoming an increasingly popular solution in public buildings and among the owners of private houses. By equipping these doors with qualitative locks, a high level of security can be guaranteed, alongside with heat and sound insulation similar to that of wooden hinged

doors. "Stal!" Ltd offers GU sliding doors with an oiled oak threshold, which provides an additional warm feeling. Accoya is another threshold option. It not only looks good and stylish, but also has high dimensional stability.

These doors can be manufactured from wood or a combination of wood and aluminium where aluminium covers the outer part of the frame and sash.

### STANDARD SPECIFICATIONS FOR GU LIFT SLIDING DOORS:

Raw material: Finger-jointed pine, solid pine or oak  
 Frame: 45 x 184 mm  
 Sash: 68 x 112 mm  
 Glass: Double glazed (24 mm) or triple glazed (36 mm) with selective coating and argon gas  
 Handle: GU – from inside, shutter – from outside  
 Threshold: Oak or Accoya  
 Hardware: GU  
 High security multi point locking mechanism  
 Finish: Varnishes or paint from RAL or NCS catalogue

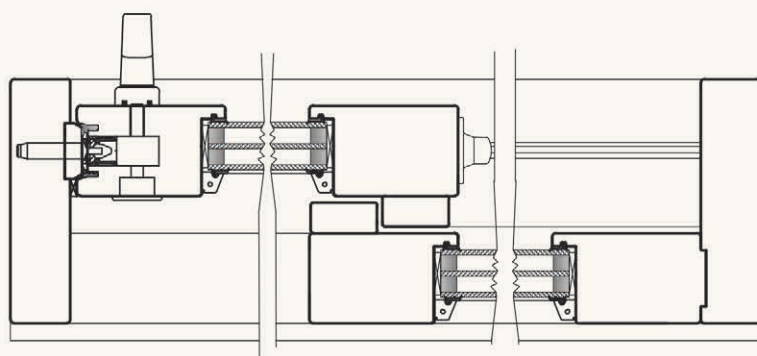

Horizontal section of the doors

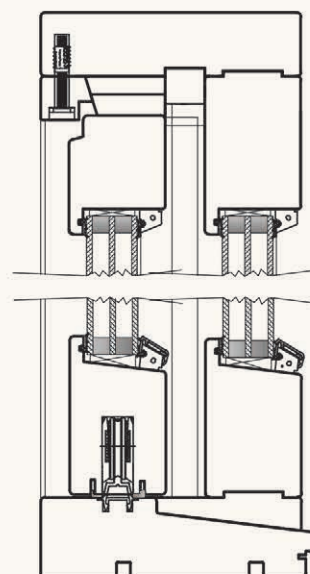

Vertical section of the doors

# SLIDING DOORS

## ROTO PATIO LIFE



Due to their functionality, sliding doors equipped with Roto hardware are very similar to GU sliding doors. Roto Patio Life sliding doors are offered with a fiberglass threshold, which facilitates maintenance of the doors. Thanks to the convenience of such thresholds, these doors are excellent for serving as a structure for dividing rooms.

The Roto hardware ensures that opening of these doors is surprisingly easy even despite the relatively large size of doors, which can reach even 6.5 m in width and 2.4 m in height.

Sliding doors are an excellent alternative for inward and outward opening doors, since they require very little space. These doors visually expand the room, ensure a flow of light and have become a component of modern interior.

In order to match doors with almost any doorway and design, we recommend assembling these doors with side lights or upper lights.

"Stalji" Ltd manufactures sliding doors made from pine or oak, adjusting their design to requirements of each particular interior and house facade. We also offer a wide range of different glazing types for this product.

These doors can be manufactured from both – wood or a combination of wood and aluminium where aluminium covers the outer part of the frame and sash.

### STANDARD SPECIFICATIONS FOR ROTO PATIO LIFE SLIDING DOORS:

Raw material: Finger-jointed pine, solid pine or oak

Frame: 45 x 181 mm

Sash: 68, 78, 90 x 112 mm

Glass: Double glazed (26 mm) or triple glazed

(36 or 48 mm) with selective coating and argon gas

Handle: Roto – from inside, shutter – from outside

Threshold: Roto Frank fiberglass

Hardware: Roto Frank

High security multipoint locking mechanism

Finish: Varnishes or paint from RAL or NCS catalogue

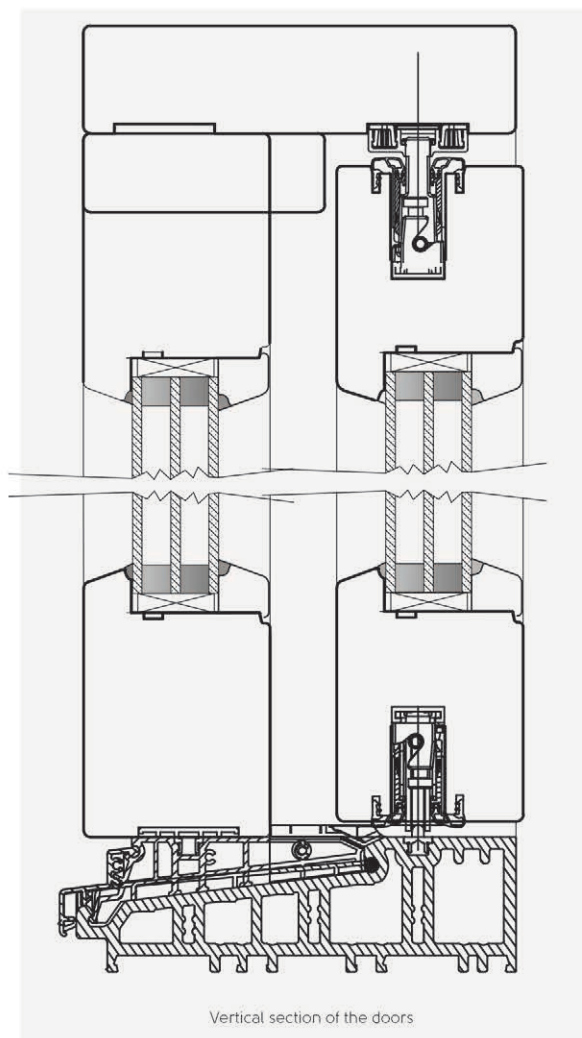



Roto Patio Z Tilt & Slide doors are an excellent alternative for large fixed frame windows and balcony doors, they ensure easy ventilation by tilting the sash, which is particularly important for families with children or pets. We offer a wide range of glazing and decorative elements so you can design these doors specifically for your interior.

We offer sliding doors equipped with Roto hardware. The benefits of the system of Roto Patio Z doors include the ease of use, functionality and space economy. "Stalji" Ltd offers to match the design and colour of sliding doors to the overall interior of the premises.

Roto Patio Z sliding doors, which are treated with an appropriate varnish, are easy to maintain and preserve their good qualities for a long period of time. Roto Patio Z sliding doors allow the room to breathe and ensure air circulation, at the same time ensuring good heat insulation and extensive design opportunities.

### STANDARD SPECIFICATIONS FOR ROTO PATIO Z TILT & SLIDE SLIDING DOORS:

Raw material: Finger-jointed pine, solid pine or oak  
 Frame: 68, 78, 90 x 82 mm  
 Sash: 68, 78, 90 x 82 mm  
 Glass: Double glazed (26 mm) or triple glazed (36 or 48 mm) with selective coating and argon gas  
 Aluminium drainage cover bar  
 Handles: Roto Frank  
 Hinges: Roto Frank  
 Threshold: Wood/aluminium  
 Finish: Varnishes or paint from RAL or NCS catalogue

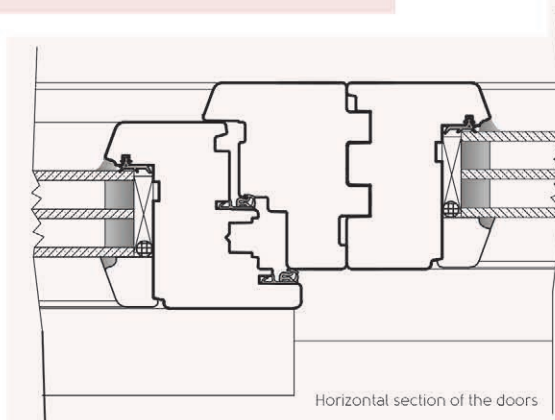
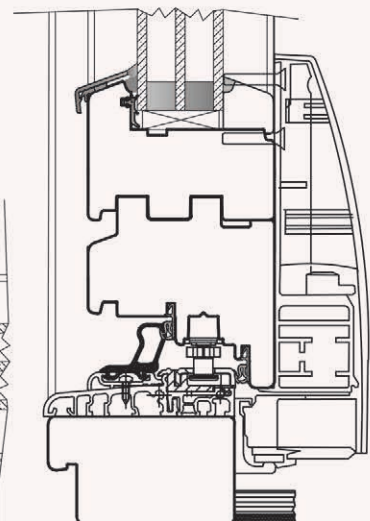
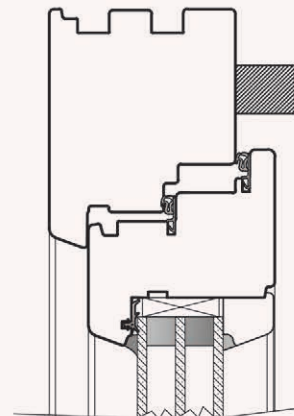

Horizontal section of the doors

Vertical section of the doors

# FOLDING DOORS

## INWARD OPENING



Inward opening folding wooden doors ensure great functionality and visually attractive appearance at the same time. This type of outer doors are most often used as an exit to the yard or terrace of the house, connecting the garden and indoors when opened.

### STANDARD SPECIFICATIONS FOR INWARD OPENING FOLDING DOORS:

Raw material: Finger-jointed pine, solid pine or oak

Frame: 68, 78, 90 x 82 mm

Sash: 68, 78, 90 x 82 mm

Glass: Double glazed (26 mm) or triple glazed (36 or 48 mm) with selective coating and argon gas

Handle: Roto Frank

Threshold: Wood or wood/aluminium

Hardware: Roto Frank

Finish: Varnishes or paint from RAL or NCS catalogue

Another positive aspect is the low wooden threshold – it gives extra comfort when walking through houses or public places.

High-quality glazing provides efficient heat and noise insulation. "Staji" Ltd offers premium quality inward opening folding doors made from finger-jointed pine, pine solid or oak.

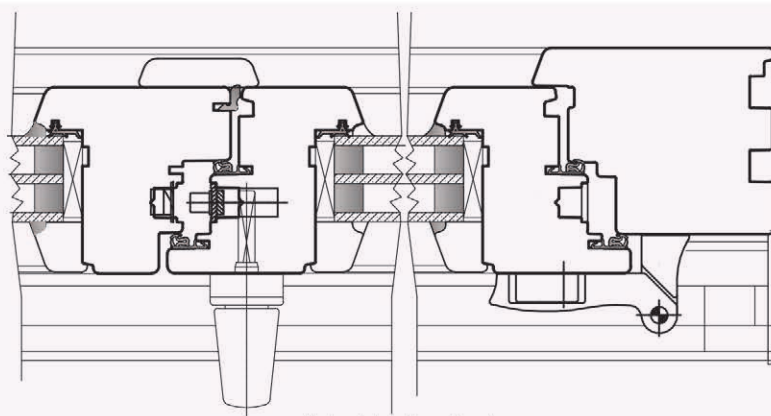

Horizontal section of the doors

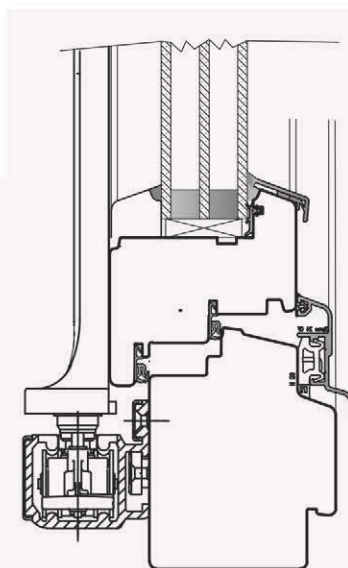

Vertical section of the doors

## FOLDING DOORS

### OUTWARD OPENING



Outward opening folding doors ensure great functionality and visually attractive appearance at the same time. Another positive aspect of these doors is the low wooden threshold – it gives extra comfort when walking through houses or public places.

“Stalji” Ltd offers outward opening folding doors with Centor hardware that ensures a very wide range of opening options and allows covering openings of different width and height.

Despite the wide sash of folding doors, which can reach up to 16 metres, they ensure efficient heat and noise insulation. It is possible to make folding doors with aluminium cladding.

These doors can be manufactured from both – wood or a combination of wood and aluminium where aluminium covers the outer part of the frame and sash.

#### STANDARD SPECIFICATIONS FOR OUTWARD OPENING FOLDING DOORS:

Raw material: Finger-jointed pine, solid pine or oak

Frame: 60 x 187 mm

Sash: Thickness 45, 63, 68, 76, 78 or 90 mm

Width of wooden parts: 82 - 115 mm

Threshold: Oak or Accoya

Glass: Double glazed (26 mm) or triple glazed (36 or 48 mm) with selective coating and argon gas

Hardware: Centor

Locking mechanism: High security multi point locking mechanism

Handles: Hoppe

Possible options: With aluminium cladding

Finishing: Varnishes or paint from RAL or NCS catalogue

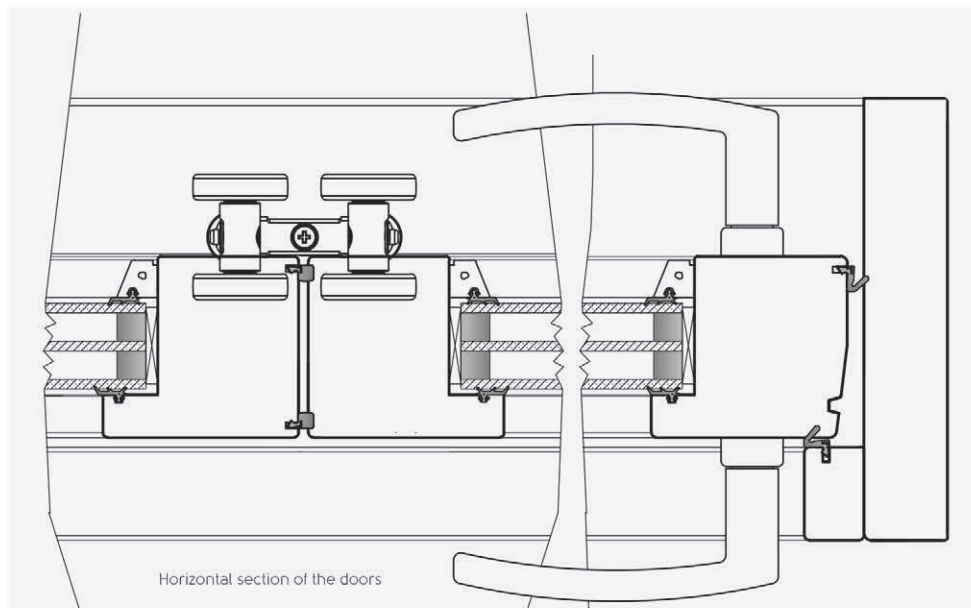

Horizontal section of the doors

# DECORATIVE CROSSBARS



**Rustic type decorative crossbars**  
Detachable, both sides



**Wooden decorative crossbars with silicone**  
Non-detachable, both sides



**Aluminium decorative crossbars "Elizabeth"**  
Between glass



**Plastic decorative crossbars with silicone**  
Detachable, outside



**Aluminium decorative crossbars**  
Detachable, outside



**Wooden (inside) and plastic (outside) decorative crossbars**  
Wooden crossbars with silicone, plastic - detachable



**Wooden (inside) and aluminium (outside) decorative crossbars**  
Wooden crossbars with silicone, aluminium - detachable



**Wooden decorative crossbar with silicone**  
Non-detachable, outside



**Wooden decorative crossbars with silicone and decorative duplex in between**  
Non-detachable, both sides

Decorative window crossbars are a way to supplement the design of any window, match it to the historical original or to create a unique design through adjusting them to the style of the building. These crossbars can be manufactured in various sizes, colours and styles, by using wood, aluminium or plastic.

Taking into consideration the unique requirements and project specifics of each customer, "Stalji" Ltd offers different technological solutions. A wide range of various profiles is available. During an individual consultation, our experts will help to make the right choice and to find the best solution.

Crossbars are fixed on glass using different means:

- Glued on the glass from one or both sides;
- With or without decorative duplex in between;
- Glass dividing bars are separate from the glazing;
- Crossbars can be placed in the middle of the glazing (the most convenient maintenance);
- Removable crossbars or a whole removable frame, which make window cleaning easier.

## Textured glass



Diamante



Chinchilla



Atlantic



Niagara



Crepi

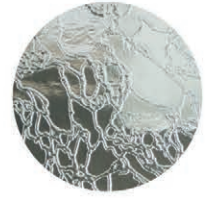

Delta

## Stained glass



Now, with increasing requirements for energy efficiency of buildings and different solutions for design, glass plays an important role.

"Stali" Ltd collaborates with the best manufacturers of glass that can supply the most modern solutions, which help to ensure the practical and design requirements of each particular project:

**Fire-proof glass** – ensures limited safety in case of fire, and will seal off hot gases emitted from the flames for a limited time;

**Sound-proof glass** – ensures excellent sound isolation and effectively drowns out any noise;

**Sun-protection glass** – absorbs the energy of sunlight and reflects it back. Due to its shielding material, the glass will ensure that sunlight will not have as much of an effect on the temperature of the room and will limit the extent to which the room is heated from sunlight.

**Self-cleaning glass** – glass with a self-cleaning coating that does not need to be cleaned as often and is more resistant to mechanical damage. The glass functions due to two natural components – the sun and the rain. The UV light of the sun dissolves dirt and makes them easier to clean. The rain washes away what is left of the dissolved dirt from the glass;

**Safety glass** - in order to take care of your safety, "Stali" Ltd offers windows and doors for safety and protection, which are, for example, equipped with tempered glass that is five times tougher than ordinary glass. If broken, it crumbles into small pieces that are less hazardous.

## COLOURS



Wooden windows and doors can be made in different shapes and they may be varnished or painted in the widest range of colours and tones, usually retaining the original texture of the wood. Aesthetic qualities are as important as the functional qualities of the wood. They offer a wide choice of applications in the modern interior – there is a possibility to create a glazing of original design or sliding doors that permit modification of the size and functions of the room. For architects and stylists there is a wide range of possibilities to find interesting

combinations with surfaces of furniture, floor and walls, as well as textiles made from organic materials. Under different lighting, the texture of wood reveals its varied beauty. Wood is an irreplaceable material when restoring buildings and rooms of historical value.

The variety of shapes, profiles and colour tones permits wooden building details to be adjusted to the styles of different periods and regional traditions by creating the impression of an authentic environment.



Many years of experience and cooperation with architects, constructors and customers allow developing and improving the production and ensuring high quality of services.

Only high-quality materials are used in manufacturing. The pinewood used in the production of windows and doors is prepared on site in our production unit, thereby allowing selection of only the best materials. "Stalji" Ltd equips windows and doors with hardware supplied by leading companies in the industry – Fix, ASSA, Roto, Spilka, Centor, and other companies.

Each year, the company invests considerably in the introduction of new products and technologies and is constantly improving. All products are tested in a certified laboratory owned by the company. The products are also sent to testing institutes all across Europe in order to ensure compliance with the relevant standards and execute all functions perfectly. Products manufactured by "Stalji" Ltd are tested in the SP Technical Institute in Sweden, British Standard Institute (BSI) in the United Kingdom and Rosenheim Certification Centre in Germany.

Great attention is paid to quality assurance. The company maintains its own quality control service, which controls and inspects products throughout the production process. Before the delivery to customers, products are repeatedly inspected for conformity with the quality standards.

## CHAIN OF CUSTODY CERTIFICATE

The company has Chain of Custody certificate, showing compliance to FSC Chain of Custody standard. The company's established control system provides full traceability of the production of materials, which ensures that the complete flow of production materials starting from supplied logs and finishing with loading and delivering our finished products can be traced. Our products, marked with FSC label are made from timber from well-managed forests.

## ISPM HT CERTIFICATE

The HT ISPM (International Standards for Phytosanitary Measures No. 15 (ISPM 15)) certificate of Thermal Processing of Wood Packaging Materials issued by BM TRADA CERTIFICATION Latvia (certification authority) certifies that the technology used for processing of wood packaging material and the process quality control complies with the International Standards For Phytosanitary Measures ISPM NO.15 (directions regarding the requirements for wood packaging materials in the international trade) and ensures thermal processing of wood materials for 30 minutes in the temperature of 56°C. This certificate allows exporting company products packaged in a material complying with the certificate to many countries, for example, the USA, Canada, United Kingdom, China and many others.

## IFT CERTIFICATE

The certificate issued by the IFT (Institut für Fenstertechnik) Rosenheim (Germany) Institute for Window Technology certifies that the production process of half-finished articles of windows and doors, as well as the quality monitoring system complies with the determined standards. The quality control system in company "Stalji" Ltd has been improved in accordance with the requirements of these standards. Auditing of the quality management system and manufactured products is performed twice a year.

## SP CERTIFICATE

The certificate issued by the SP (SP Sveriges Tekniska Forskningsinstitut) Swedish National Testing and Research Institute certifies that the production process of half-finished articles of windows and doors, as well as the quality monitoring system complies with the determined standards. By observing the changes in these standards, accordingly, the respective quality monitoring systems are also improved. This certificate ensures recognition and sales opportunities in Scandinavian countries for the products manufactured by "Stalji" Ltd.

## NDVK CERTIFICATE

NDVK (Norsk Dør-og Vinduskontroll) is a Norwegian government certified control centre for manufacturers of windows and doors, which certifies, inspects and controls that products comply with the requirements and standards determined by the Norwegian government. In order to obtain the rights of distribution of manufactured products with the NDVK quality marking, a manufacturer is required to perform tests and certification for various types of products. After obtaining the NDVK certificate, regular inspection of production processes is performed in the company that ensures constant quality of the products.





## PREMIUM QUALITY WOOD PELLETS

Wood pellets are a type of biomass fuel, which allows using captured solar energy for heating. They are a renewable and environmentally friendly fuel.

"Stali" Ltd produces high-quality wood pellets from the chips of freshly sawn softwood saw logs left over in the production of windows, doors and other products. Thus, the wood can be used completely. Regular quality tests carried out during the production process show that the company offers one of the best pellets in Europe. This is also confirmed by the compliance of results of the tests carried out by SGS (the world's leading and recognized testing, inspection and certification company) on the premium quality wood pellets. Accordingly, in 2013, company received the German DINplus certificate and, at the beginning of 2015, the European certificate Enplus-A1.

Wood pellets are manufactured using a specific technology developed by the company that ensures careful processing of the wood pellets, thus providing the highest quality.

We offer packing pellets in bags designed by "Stali" Ltd or in bags provided by client. Pellets are packed on wooden pallets using a special automated packaging and wrapping technology that protects pellets against adverse weather effects (rain, snow, UV rays, etc.) and allows storage of the product outdoors. We offer the opportunity to pack bags of pellets on a wooden pallet in different combinations.

### STANDARD PACKAGING OPTIONS



**WE PRODUCE:** 6 mm and 8 mm pellets;

**WE USE:** pure wood (without additives and bark) for production;

**MECHANICAL DURABILITY:**  $\geq 98 \%$ ;

**MOISTURE CONTENT:**  $\leq 10 \%$ ;

**LENGTH:**  $3,15 \leq L \leq 40 \text{ mm}$ ;

**ASH CONTENT:**  $\leq 0,7 \%$ ;

**PRODUCED FROM:** softwood (spruce and pine);

**BULK DENSITY:**  $600 \leq BD \leq 750 \text{ Kg/m}^3$ ;

**FINES:**  $(<3,15 \text{ mm}) \leq 1 \%$ ;

**NET CALORIFIC VALUE:**  $16,5 \leq Q \leq 19 \text{ MJ/Kg}$ ;

**SPECIAL PRODUCTION TECHNOLOGY DESIGNED BY THE COMPANY;**

**CONTINUOUS QUALITY CONTROL THROUGHOUT THE PRODUCTION PROCESS.**

## ENPLUS CERTIFICATE

ENplus was first introduced in Germany in 2010 and since then the certification has enjoyed a rapid expansion across Europe. The ownership of the ENplus trademark remains with the European Biomass Association AEBIOM. This certificate not only fulfils the EN 14961-2 provisions, but requires even stricter quality criteria. This quality seal stands for low emissions and trouble-free heating with high energy value. For the first time, the entire supply chain is covered by a single certification system.

The ENplus quality seal accounts for the entire wood pellet supply chain – from production to delivery to the final customer, therefore ensuring high quality as well as transparency. In 2014, a total of 6.5 million tonnes of ENplus certified pellets has been produced. This represents approximately 60% of the total pellets consumed for heating in Europe.

## DINPLUS CERTIFICATE

The quality mark DINplus, with its strict requirements, is an established quality mark for wood pellets with around 200 certificate holders worldwide. Not only in Europe, traders and consumers of wood pellets trust in the DINplus certification. Wherever there is a need for high-quality wood pellets, this is the trusted certification. Therefore, producers of central heating boilers and furnaces like to emphasize how important it is to use only wood pellets with the quality mark DINplus, because by using DINplus certified wood pellets, boiler issues can be reduced to the minimum.

The DINplus quality mark creates customer confidence. They can rest assured that an independent, neutral and dedicated institution has carefully investigated and reviewed all the certification criteria for wood pellets and wood pellets production. External monitoring ensures that the product quality is maintained during production. All of which provides customers with added value that will help them to decide which product to purchase. Wood pellets for use in small furnaces receive the quality mark DINplus, if they fulfil the requirements of European Standard DIN EN 14961-2 and others defined in the Certification Scheme of DIN CERTCO. It was the first certification body, which started with the certification of wood pellets in 2002. Since then it has established itself as the leading certification body in this area.

## CHAIN OF CUSTODY CERTIFICATE

The company has Chain of Custody certificate, showing compliance to FSC Chain of Custody standard. The company's established control system provides full traceability of the production of materials, which ensures that the complete flow of production materials starting from supplied logs and finishing with loading and delivering our finished products can be traced. Our products, marked with FSC label are made from timber from well-managed forests.





[www.stali.lv](http://www.stali.lv)

